

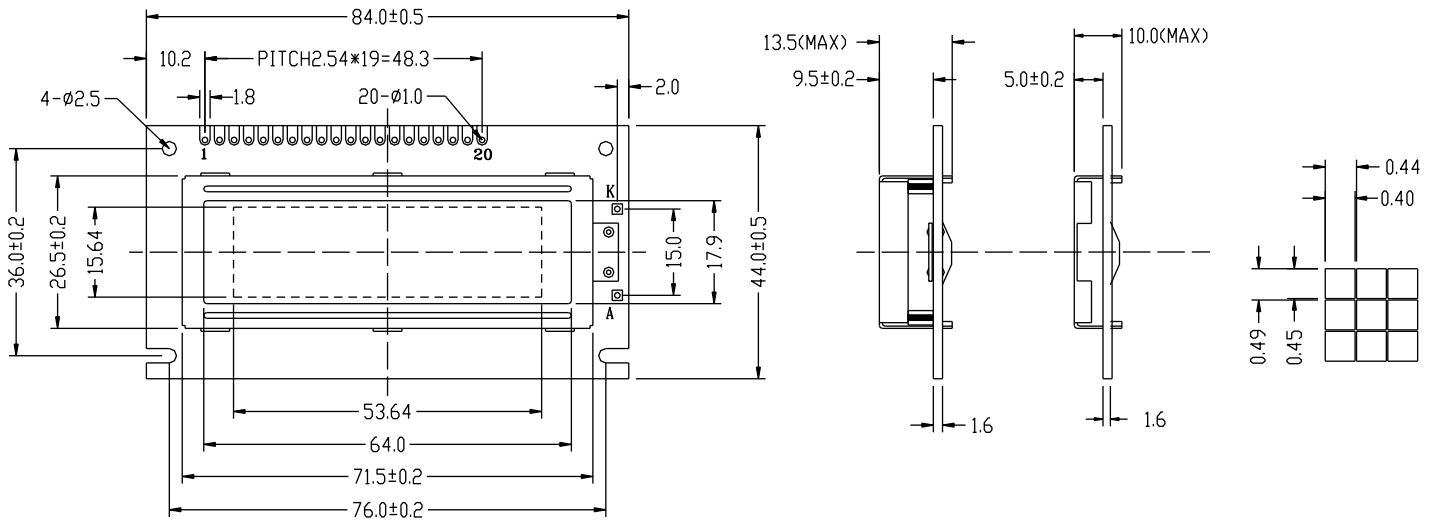

**Outline Dimension**



**Feature**

1. 122X32 dots graphic LCD module
2. Built in controller (SED1520)
3. +5V Power supply
4. STN ; 1/32 duty
5. Built in 8192 chinese fonts

**Mechanical Data**

Item	Standard	Unit
Module dimension	84.0x44.0	mm
Viewing area	64.0x17.9	mm
Dot size	0.40x0.45	mm
Dot pitch	0.44x0.49	mm

PIN NO	Symbol	Fuction
1	VSS □	GND
2	VDD □	+5V
3	V0 □	Constrast adjustment
4	A0	H/L H:Data L:Instruction code
5	CS1 □	Chip select for IC1
6	CS2	Chip select for IC2
7	CL □	
8	E □	Chip enable signal
9	R/W □	H/L Read/write signal
10	DB0~DB7	H/L Data bus line
11	/RES □	Reser signal
15	A	Power supply for BKL (+4.2V)
16	K	Power supply for BKL(0V)

**Absolute Maximum Rating**

Item	Symbol	Standard			Unit
		Min	Typ	Max	
Power supply	VDD-VSS	-0.3	-----	5.5	V
Input voltage	VI	-0.3	-----	VDD	

**Electronical characteristics**

Item	Symbol	Condition	Standard			Unit
			Min	Typ	Max	
Input voltage	VDD	+5V	4.7	5.0	5.5	V
		+3.3V	2.7	3.0	5.3	V
Supply current	I <sub>DD</sub>	VDD=5V	-----	2	4	mA
Recommended LCD riling voltage for normal temp version module	VDD-V0	-20°C	-----	-----	-----	V
		0 °C	4.7	5.0	5.5	
		25°C	4.3	4.5	4.7	
		50°C	4.1	4.3	4.5	
		70°C	-----	-----	-----	

**Display character address code:**

	1	2	3	4	5	6	7
DDRAM address	00	01	02	---	---	---	07H
DDRAM address	10	11	12	---	---	---	17H